

6.6 A Current Controlled Halogen - Pk30d Base Lamps for Series Operation

Areas of application

- Airfield Lighting



Product features and benefits

- Low maintenance costs due to long lamp life
- Consistent light output over the life of the lamp
- Durable construction provides resistance to the effects of vibration
- IR radiation provides guidance in low visibility conditions and facilitates defrosting in cold climates
- FAA approved in conjunction with many OEM fixtures
- Dimmable
- Flicker-free operation
- Ability to reduce light output when needed
- Mercury-free



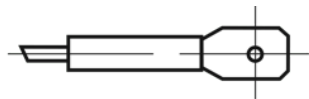

Connector C, male flat

PK30d Connector C male flat

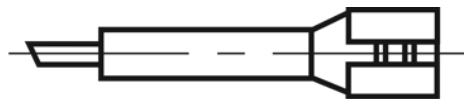

Connector A, female

PK30d Connector A female

Product family datasheet

Technical data

| | General Product Information | Electrical Data | | Lifetime Data |
|----------------------|-----------------------------|-----------------|-----------------|------------------|
| Product description | LIF code | Nominal wattage | Nominal voltage | Nominal lifetime |
| 64319 Z/C 45-15 | - | 45 W | 6.8 V | 1500 hr |
| 64317 C 45-15 | J1/76 | 45 W | 6.8 V | 1500 hr |
| 64317 IRC-C 45-30 | J1/76 | 45 W | 6.82 V | 3000 hr |
| 64318 A 45-15 | J1/77 | 45 W | 6.8 V | 1500 hr |
| 64328 HLX-A 65-15 | - | 65 W | 9.8 V | 1500 hr |
| 64328 HLX-Z/C 65-15 | - | 65 W | 9.8 V | 1500 hr |
| 64341 HLX-A 100-15 | J1/79 | 100 W | 15.2 V | 1500 hr |
| 64341 HLX-Z/C 100-15 | J1/79 | 100 W | 15.2 V | 1500 hr |
| 64342 HLX-C 100-15 | J1/80 | 100 W | 15.2 V | 1500 hr |
| 64361 HLX-A150-15 | J1/83 | 150 W | 22.7 V | 1500 hr |
| 64361 HLX-Z/C150-15 | J1/83 | 150 W | 22.7 V | 1500 hr |
| 64382 HLX-A 200-15 | J1/84 | 200 W | 30.3 V | 1500 hr |
| 64318 Z/C 45-15 | J1/77 | 45 W | 6.8 V | 1500 hr |
| 64319 A 45-15 | - | 45 W | 6.8 V | 1500 hr |
| 64382 HLX-C 200-15 | J1/84 | 200 W | 30.3 V | 1500 hr |

Product family datasheet

Safety advice

To prevent personal injury or damage to property, halogen lamps may only be operated in suitable luminaires designed with suitable mechanisms (protective shields, grids, etc.) to ensure that in the event of a lamp bursting no parts/shards can escape and that during operation no ultraviolet radiation can escape. There must also be a warning sign to indicate that the lamps give off high levels of heat. Detailed information is available on request.

Application advice

For more detailed application information and graphics please see product datasheet.

Disclaimer

Subject to change without notice. Errors and omission excepted. Always make sure to use the most recent release.